

Melchior Zeigler

Courses and Distances
Down Elk Creek ~

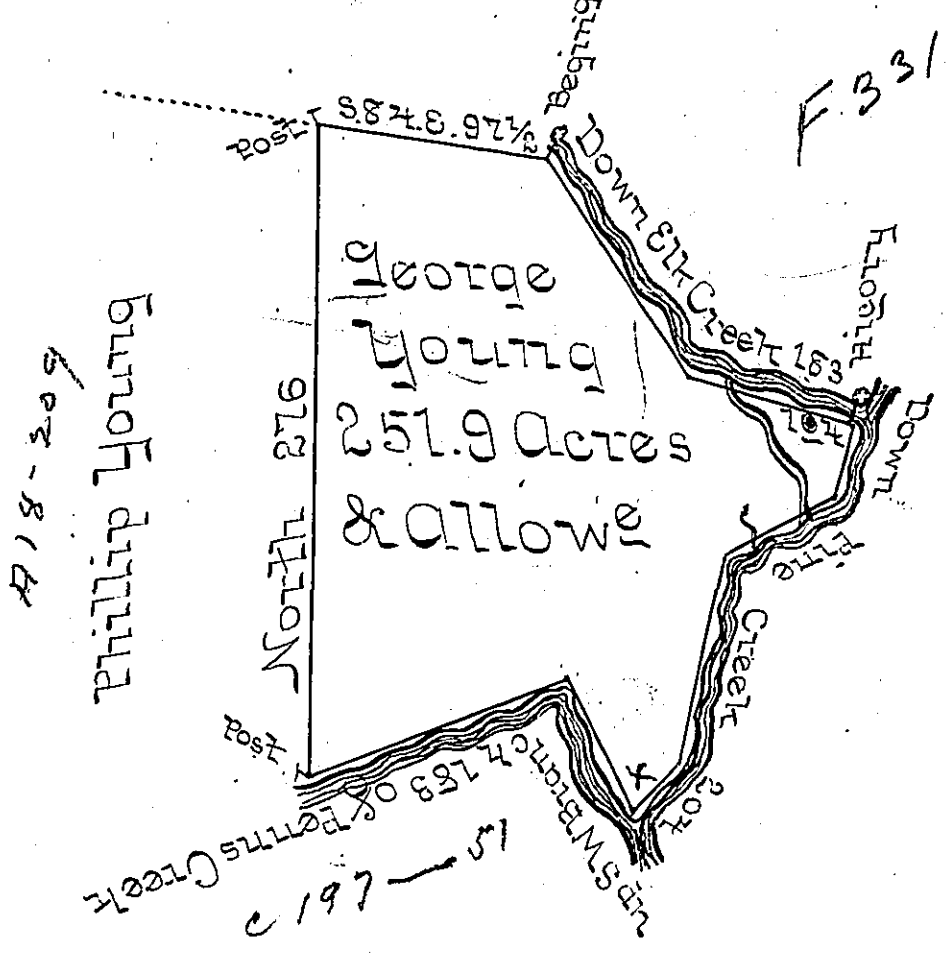

S 36 E 110
 S 75 E 74
 184

To Hickory on Pine Creek
and Down The same

S 15 W 30
 S 60 W 56
 S 11 W 82

To the
Junction of the Branches
and up the SW. Branch

S 47 W 26
 N 30 W 64
 S 68 W 119 To Post
 183

The Drought of a Tract of Land called Interfluvia
situate in the Forks of Penns Creek and on the West side
of Elk Creek in the County of Cumberland containing
Two Hundred Fifty One Acres One Hundred Sixty Six
Perches with the usual Allowance of Six Acres Per Cent
for Roads Surveyd. The 1st Day of October 1766 ~ In
Pursuance of an Order of Survey No 496 to George
Young Bearing Date at Philadelphia the first Day
of August anno Domini 1766 ~

P. Wm MacLay Deply. Survey

To John Lukens Esq Surveyr
of the Province of Pennsylvania }

IN TESTIMONY that the above is a copy of the original remaining on file in the
Department of Internal Affairs of Pennsylvania, made con-
formably to an Act of Assembly approved the 16th day of
February, 1833, I have hereunto set my Hand and caused
the Seal of said Department to be affixed at Harrisburg, this

Sixth day of October 1897

James W. Pitta
 Secretary of Internal Affairs.